

# SKIL MODEL HD5510 TYPE 1 5½" POWER SAWS

**WARNING!** Electrical repairs should be attempted only by trained repairmen. Contact the nearest SKIL Service Center or other competent repair service.

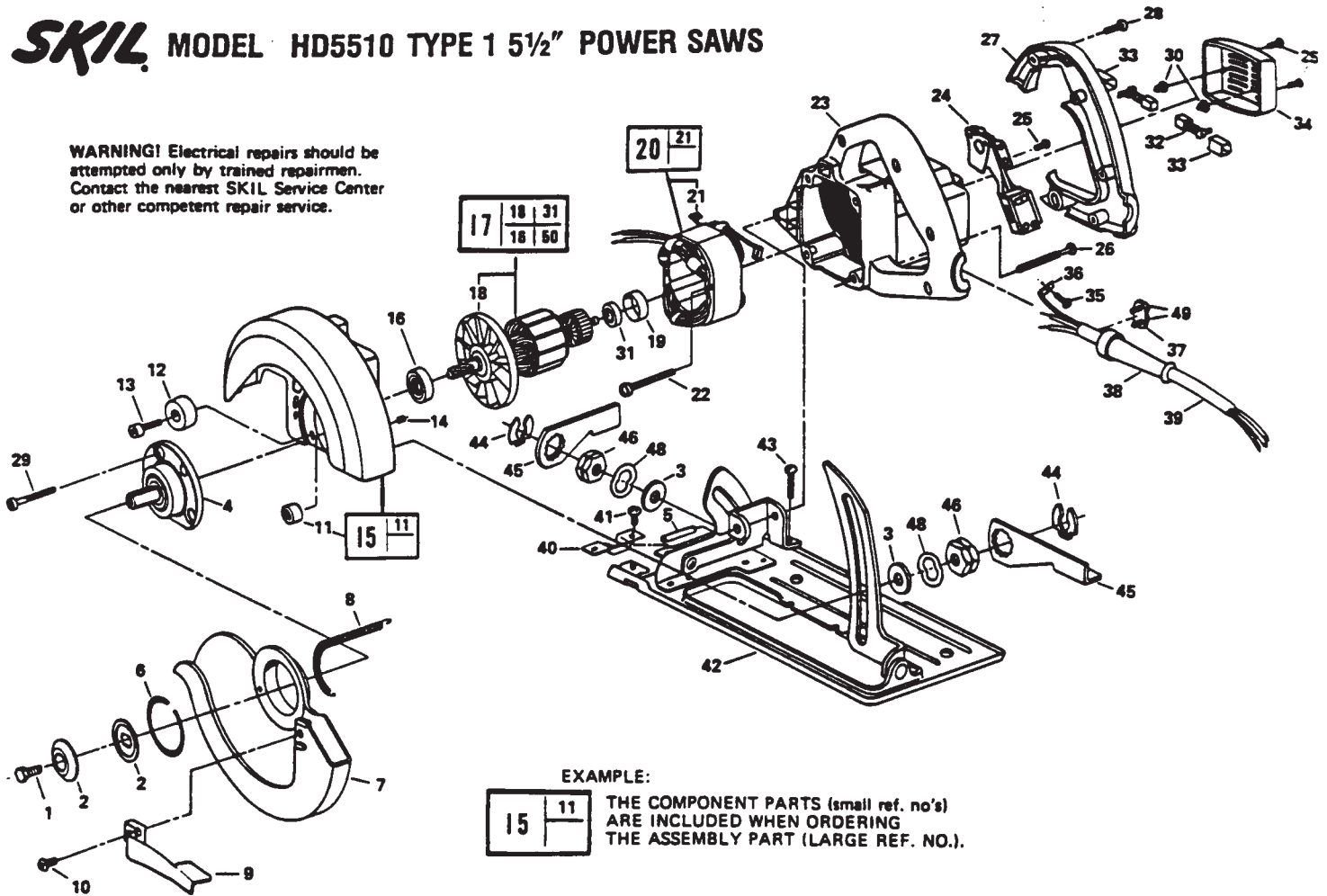

EXAMPLE:



THE COMPONENT PARTS (small ref. no's) ARE INCLUDED WHEN ORDERING THE ASSEMBLY PART (LARGE REF. NO.).

REF. NO.	PART NO.	PART NAME
1	323525	BLADE STUD
2	323519	BLADE WASHER (2)
3	27372	WASHER (2)
4	348701	GEAR ASSEMBLY
5	17975	ROLL PIN
6	323523	RETAINER RING
7	323509	LOWER GUARD
8	323522	SPRING
9	323520	LIFT LEVER
10	341365	SCREW
11	318764	SLEEVE BEARING
12	29568	STOP
13	309976	SCREW
14	317545	RUBBER PLUG
15	323506	UPPER GUARD
16	26330	BEARING
17	357531	ARMATURE
18	323549	FAN
19	320523	BEARING CUP
20	323514	FIELD
21	304129	TERMINAL (2)
22	318791	SCREW (2)
23	905305	MOTOR HOUSING
24	27519	SWITCH
25	315299	SCREW (3)
26	323524	SCREW (4)
27	905304	HANDLE COVER
28	315380	SCREW (5)
29	323540	SCREW (4)
30	323547	RUBBER CLAMP (2)

REF. NO.	PART NO.	PART NAME
31	67674	BALL BEARING
32	323544	BRUSH & SPRING (2)
33	323543	BRUSH HOLDER (2)
34	905303	BRUSH COVER
35	320173	SCREW (GROUND)
36	316596	TERMINAL
37	64973	CORD CLAMP
38	313327	CORD GUARD
39	315850	CORD & CAP
40	323545	LINE GUIDE
41	302102	SCREW (2)
42	323526	FOOT ASSEMBLY
43	347488	SCREW
44	302855	RETAINER RING (2)
45	319375	LEVER (2)
46	356673	LOCK NUT (2)
47	□ 95005	WRENCH, BLADE STUD
48	68894	WASHER (2)
49	352373	SCREW
50	10628	SNAP RING

**NOTES:**

• WHEN REPLACING No. 323506 UPPER GUARD, ALSO ORDER No. 317545 RUBBER PLUG (Ref. 14).

□ ACCESSORY (Not Shown)



January 1998  
**TECHNICAL  
 BULLETIN**

**Section 7 - Saws**

"new locking lever parts"

model(s) affected

**HD5510  
 5510**

To: All Authorized and Factory Service Centers,  
 Field Sales and Internal Support Personnel

Re: New Locking Lever Parts for models HD5510 (F012551000) Type 1  
 5510 (00055100001) Type 1

Please insert this bulletin into the "Technical Bulletins" section of your Skil Parts Manual, only after making any additions or notes to your Illustrated Parts List(s).

Please be advised that a change has been made to the locking lever parts on the above listed models. If your tool has position 48 Spring Washer, use the "old" part numbers for repairs. Otherwise, use the "new" parts for repairs. Old parts and new parts are not interchangeable except for position 3 Flat Washer which is unchanged. You may upgrade older tools by using all of the "new" parts together.

<u>Position No.</u>	<u>Description</u>	<u>Old Part Numbers</u>	<u>New Part Numbers</u>
3	Flat Washer	2 610 027 372	2 610 027 372
44	Retaining Ring	2 610 302 855	2 610 968 747
45	Locking Lever	2 610 319 375	2 610 968 745
46	Lock Nut	2 610 356 673	2 610 993 522
48	Spring Washer	2 610 068 894	not needed

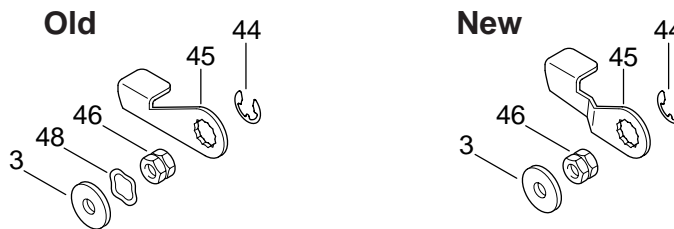

All questions should be directed to your Authorized Service Manager.

*Gail D. Fred*

Gail D. Fred  
 Product Service Department