

SKIL MODEL 6915 TYPE 1 ADJUSTABLE CLUTCH SCREWDRIVER

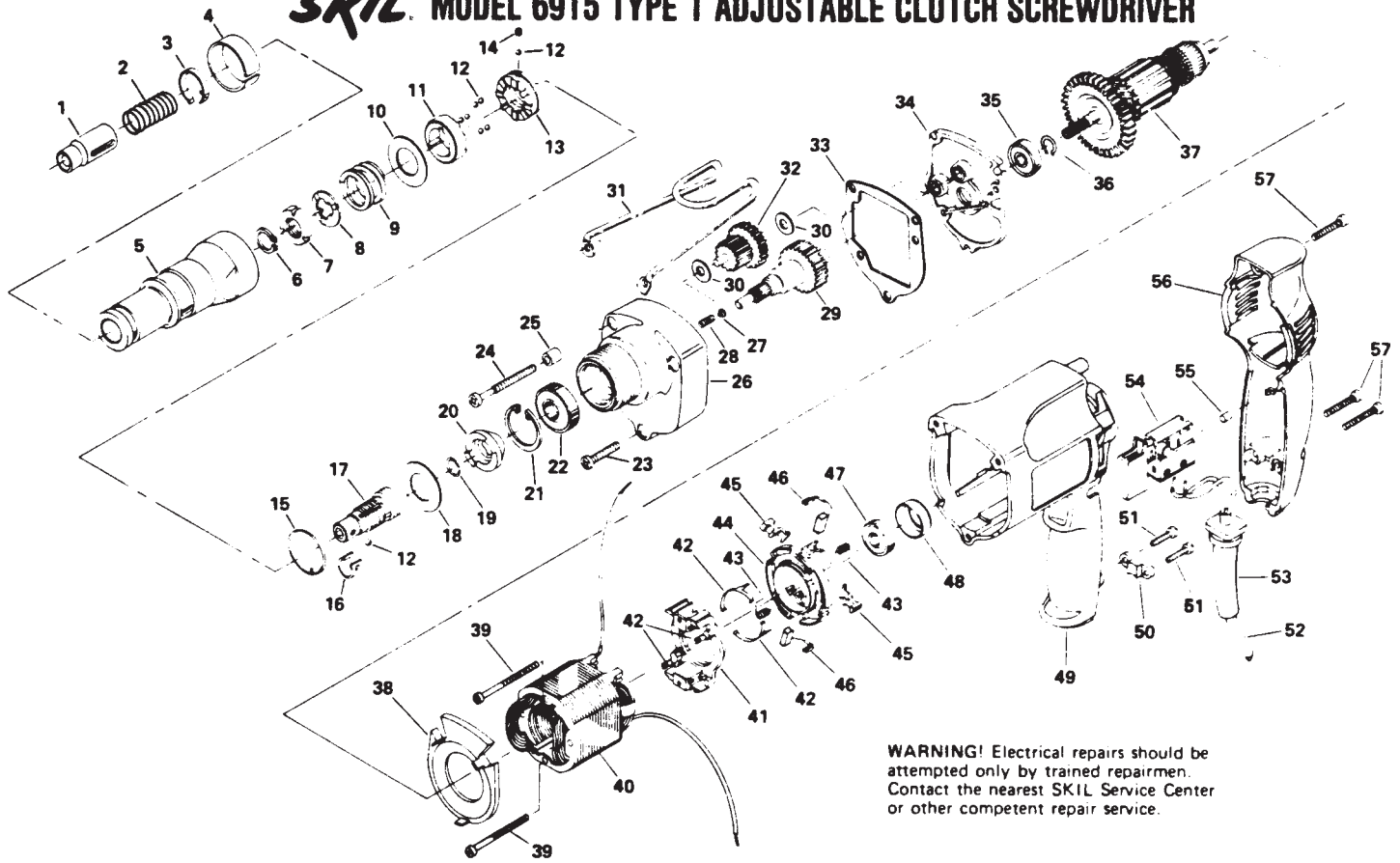

WARNING! Electrical repairs should be attempted only by trained repairmen. Contact the nearest SKIL Service Center or other competent repair service.

REF. NO.	PART NO.	PART NAME
1	*	FINDER
2	21280	SPRING
3	22698	RETAINER ASSY.
4	350791	COVER
5	350750	BONNET
6	67431	RETAINING RING
7	68485	COLLAR
8	19894	DETENT WASHER
9	6710	SPRING
10	67444	WASHER
11	4799	SLIP CLUTCH
12	* 2144	BALL (18)
13	4798	DOUBLE CLUTCH
14	6714	SET SCREW
15	6718	LOCK RING
16	21265	SPRING
17	67429	CLUTCH SPINDLE
18	350760	WASHER
19	25678	RETAINING RING
20	67430	CLUTCH JAW
21	348646	RETAINING RING
22	15747	BALL BEARING
23	348621	SCREW
24	350943	SCREW (2)
25	350941	SPACER (2)
26	350756	GEAR HOUSING
27	15236	BUTTON
28	15241	SPRING
29	350759	OUTPUT SHAFT ASSY.

REF. NO.	PART NO.	PART NAME
30	348611	WASHER
31	350939	HIP CLIP
32	348580	INTERMEDIATE GEAR ASSY.
33	348570	GASKET
34	348595	BEARING PLATE ASSY.
35	351861	BALL BEARING
36	18632	RETAINING RING
37	348589	ARMATURE ASSEMBLY
38	348586	BAFFLE
39	348628	SCREW
40	350354	FIELD ASSY.
41	348613	STATIONARY CONTACT CARRIER
42	350352	CONTACT SET
43	350351	SPRING SET
44	348614	REV. SWITCH & BRUSH HOLDER
45	348615	REVERSE LEVER
46	350350	BRUSH SET
47	351861	BALL BEARING
48	326023	SLEEVE
49	348585	MOTOR HOUSING
50	64973	CORD CLAMP
51	315386	SCREW
52	350903	CORD & PLUG
53	313327	STRAIN RELIEF
54	348551	SWITCH
55	28780	RUBBER PLUG
56	348584	HANDLE COVER
57	348622	SCREW

FINDER NUMBER

FOR USE WITH SCREW SIZES

FINDER NUMBER	FOR USE WITH SCREW SIZES	
	FLAT HEAD	ROUND HEAD
21274	4	5
21275	5	6
21276	6	8
21277	8	10
21278	10	12
21279	12	14

NOTES:

- * 1 USED IN #67429 CLUTCH SPINDLE.
- 6 USED IN #4799 SLIP CLUTCH;
- 11 USED IN #4798 DOUBLE CLUTCH;