

SKIL MODEL 6345 TYPE 2 CODE 78 DRILL

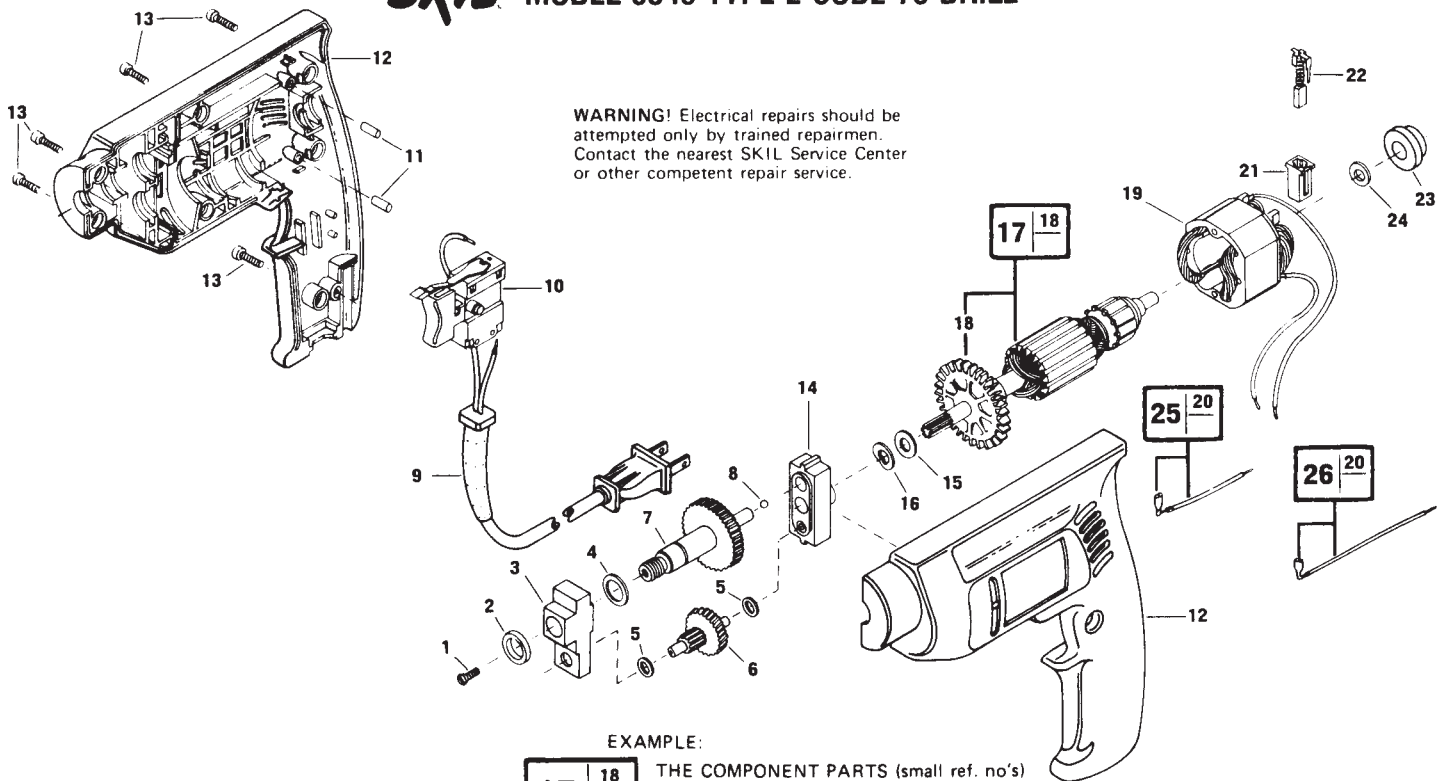

EXAMPLE:



THE COMPONENT PARTS (small ref. no's) ARE INCLUDED WHEN ORDERING THE ASSEMBLY PART (LARGE REF. NO.).

REF. NO.	PART NO.	PART NAME
1	315857	SCREW
2	17642	FELT WASHER
3	347305	SPINDLE BLOCK ASSY
4	313808	WASHER
5	309996	WASHER (2)
6	357542	GEAR ASSY
7	902910	SPINDLE ASSY
8	2144	BALL
9	313328	CORD
10	358235	SWITCH
11	28780	RUBBER PLUG
12	321613	HOUSING SET
13	326578	SCREW (7)

REF. NO.	PART NO.	PART NAME
14	352355	BEARING BLOCK ASSY
15	27445	WASHER
16	26126	SPRING WASHER
17	352027	ARMATURE
18	346332	FAN
19	321618	FIELD
20	304129	TERMINAL
21	320548	BRUSH HOLDER (2)
22	321617	BRUSH SET
23	351348	BEARING
24	29973	WASHER
25	320494	LOWER BRUSH LEAD
26	39904	UPPER BRUSH LEAD

● NOTE: ASSEMBLE WITH BOW TOWARD BEARING.

SKIL CORPORATION • SUBSIDIARY OF EMERSON ELECTRIC CO.
4300 W. PETERSON AVENUE • CHICAGO, IL 60646

F-903363 5/92
PRINTED IN U.S.A.