

PORTER-CABLE

TIGER CUB[®]

ALL PURPOSE SAW

U. S. PAT. D332, 921

WARNING: Electrical repairs should only be attempted by trained repairmen. Contact the nearest Porter-Cable Service Center or other competent repair center

647

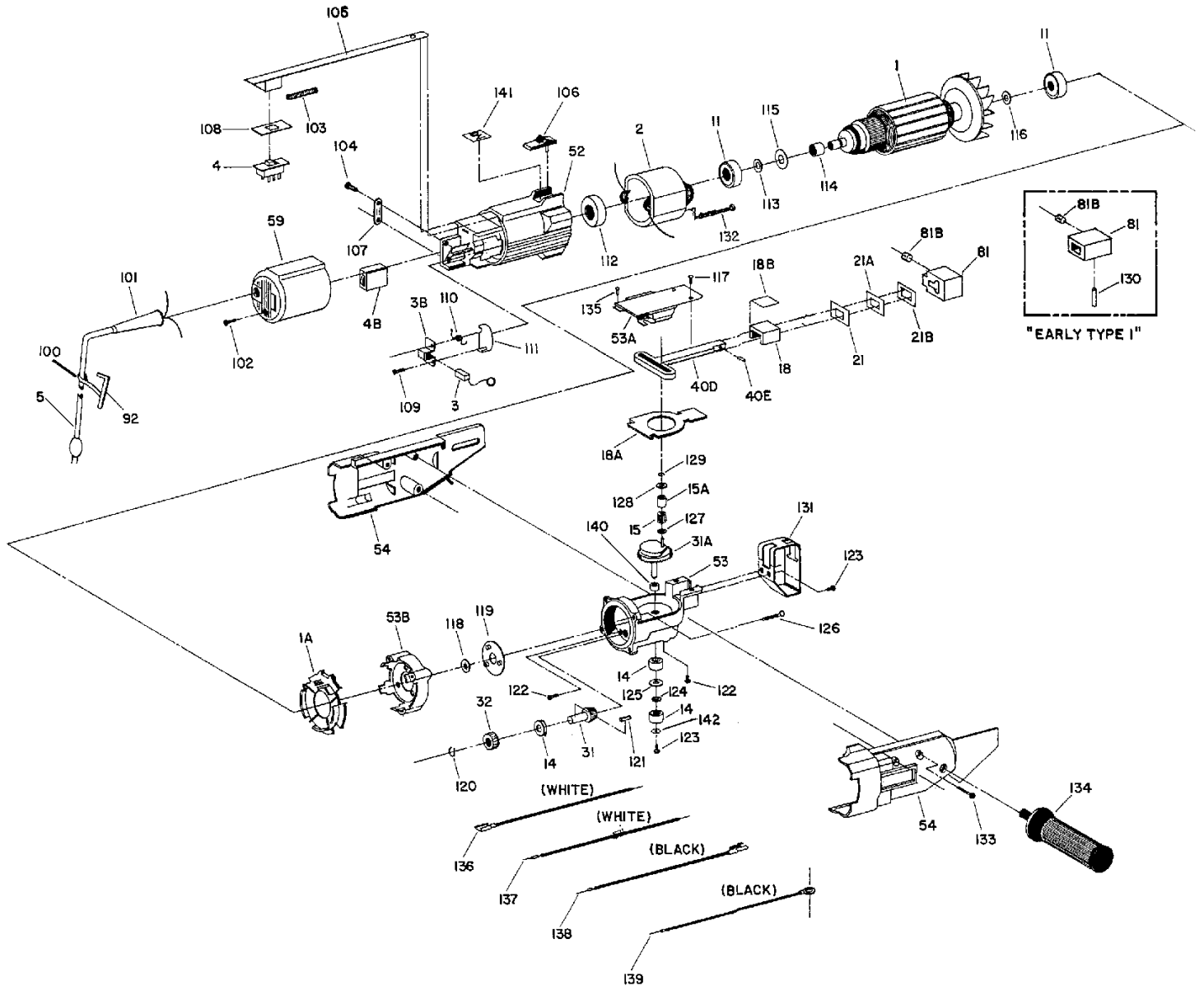

Ref. No.	Part No.	Description	Ref. No.	Part No.	Description
1	695763	Armature	126	699085	Screw
1A	698153	Fan Baffle	127	698603	Washer
2	695762	Field	128	858792	Washer
3	690741	Brush	129	693991	Retaining Ring
3B	690742	Brush Holder	130	698602**	Rolled Pin
4	694006	Slide Switch	131	698157	Shoe
4B	693971	Speed Control	132	695185	Screw
5	872258	Cord	133	847668	Screw
11	855284	Bearing	134	698739	Aux. Handle, T1, T2
14	855219	Bearing	135	850596	Screw
15	858779	Rollers and Cape	136	694155	Lead
15A	861509	Roller	137	694018	Lead
18	872041**	Recip. Bearing	138	693984	Lead
18A	698163	Wear Plate	139	694017	Lead
18B	872012**	Shim , Early T1	140	872502	Spacer, T2, T3 (1 req'd.)
21	698612	Seal		851584	Spacer, T1 (2 req'd)
21A	698611	Seal	141	873307	"On" Label, T2, T3
21B	874482	Seal Retainer		699987	"On" Label, T1
31	872788	Pinion & Shaft Assy., T2, T3	142	802417	Lockwasher
	698167**	Pinion Gear, T1	*	698970	Carrying Case
31A	872787	Gear Assy., T2, T3 Incl. Ref. 15, 15A, 127, 128, 129	*	811292	Armature Fan, Current, Fan on Tube
	872943	Gear Assy., T1 Incl. Ref. 15, 15A, 127, 128, 129	*	811246	Armature Fan, Early, Fan on Shaft
32	698169**	Idler Gear	*	48220*	Lubricant, 5 1/2 oz.
40D	872785	Recip. Shaft Assy., T1 After S/N 030856, T2, T3	*	874809*	Lubricant, 4 lbs.
		Incl. Ref: Ref. 40E	*	872786**	Kit for converting T1 recip. Shaft & Blade Clamp to T2
	872786	Recip. Shaft Conversion, T1 Before S/N 030856			
		Incl. Ref. 40E, 81, 81B, 92			
	698164**	Recip. Shaft Assy., T1, Incl: Ref. 40E	*	Not Shown	
40E	876734	Blade Locator Dowel Pin, T1 After S/N 030856, T2, T3	**	See Service Notes	
	800835**	Blade Locator Drive Screw, Late T1			
	698179**	Blade Locator Dowel Pin, Early T1			
52	698728	Motor Hsq.			
53	885663	Gear Hsq., T3			
	872656	Gear Hsq., T2			
	698171	Gear Hsq., T1			
53A	698162	Gear Hsq. Cover			
53B	698155	Intermediate Hsq.			
54	885659	Cover Set, T3			
	698177	Cover Set, T1, T2			
59	698738	End Cap, T1, T2			
81	876793	Blade Clamp & Pin, Incl: Ref. 40E			
		T1 after s/w 030856, T2)			
	698396**	Blade Clamp, T1 Before S/N 030856			
81B	847423	Blade Screw, T1 After S/N 030856, T2, T3			
	698569	Blade Screw, T1 Before S/N 030856			
92	48248	Blade Wrench, T1 After S/N 030856, T2, T3			
	48245	Blade Wrench, T1 Before S/N 030856			
100	842323	Wrench Holder			
101	810882	Strain Relief			
102	694012	Screw			
103	698536	Spring			
104	694438	Screw			
105	698537	Actuator, Switch			
106	873697	Switch Button & Slide Pkg.			
107	861434	Cord Clamp			
108	694924	Dust Shield			
109	854805	Screw			
110	868775	Brush Spring			
111	690740	Brush Holder Base			
112	694432	Bearing Mount			
113	849328	Spacer			
114	698394	Insulating Tube			
115	695893	Fiber Washer			
116	847564	Snap Ring			
117	698550	Screw			
118	862534	Slinger			
119	698178	Grease Plug			
120	801306	Nut, T2, T3			
	698165	Snap Ring, T1			
121	698202	Key			
122	872997	Screw			
123	698214	Screw & Washer			
124	698159	Spacer			
125	698158	Spacer			

IDLER GEAR/PINION GEAR

It is recommended the idler gear (Ref. 32) and pinion gear (Ref. 31) be removed as an assembly. This may be accomplished by utilizing the two screws (Ref. 122 as "jack-screws" to force the assembly out of the housing: rotate one screw, then the other, approximately one-half turn counter-clockwise. Repeat until assembly is free.

BEARING/RECIPROCATING SHAFT/SHIM (TYPE 1)

Units below serial number 013000 should have the reciprocating shaft (Ref. 40D) and bearing (Ref. 18) replaced as a set (when replacement of either is required). Some of these early units have a rubber bumper on top of the bearing (Ref. 18). This bumper should be discarded when a replacement bearing and reciprocating shaft are installed.

Units above S/N 013000 (t1) were built with either (a) reciprocating bearing #698160, or (b) reciprocating bearing #698160 and shim #872012. Replacement bearing #872041 is used to service all units and requires no shim.

RECIPROCATING SHAFT/BLADE LOCATOR

BEFORE S/N 030856:

Early Type 1 units (before S/N 027400) utilized a small dowel pin to locate the blade. Type 1 units after S/N 027400 utilize a drive screw to locate the blade.

AFTER S/N 030856:

Later units have a thru pin to locate the blade and the blade clamp.

Conversion kit #872786 contains the necessary components to convert an early tool to the improved reciprocating shaft and blade holder. Kit #872786 includes Ref. 40D, 40E, 81, 81B, 92.

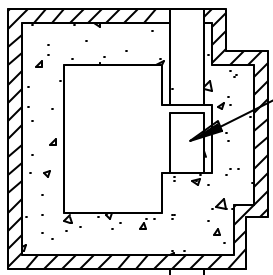
BLADE CLAMP/ROLLED PIN (TYPE 1 - BEFORE S/N 030856)

NOTE: Pin must not contact upper section of block.

It is recommended when servicing the blade clamp area of these early machines that they be converted to the latter style components by installing 872786 kit.

LUBRICANT

Several types of lubricants have been used. It is recommended any unit requiring additional lubrication be thoroughly cleaned and repacked with the current lub.