

# PORTER-CABLE

## ROUTER

6301  
6302  
6702  
6902  
513T6/T7

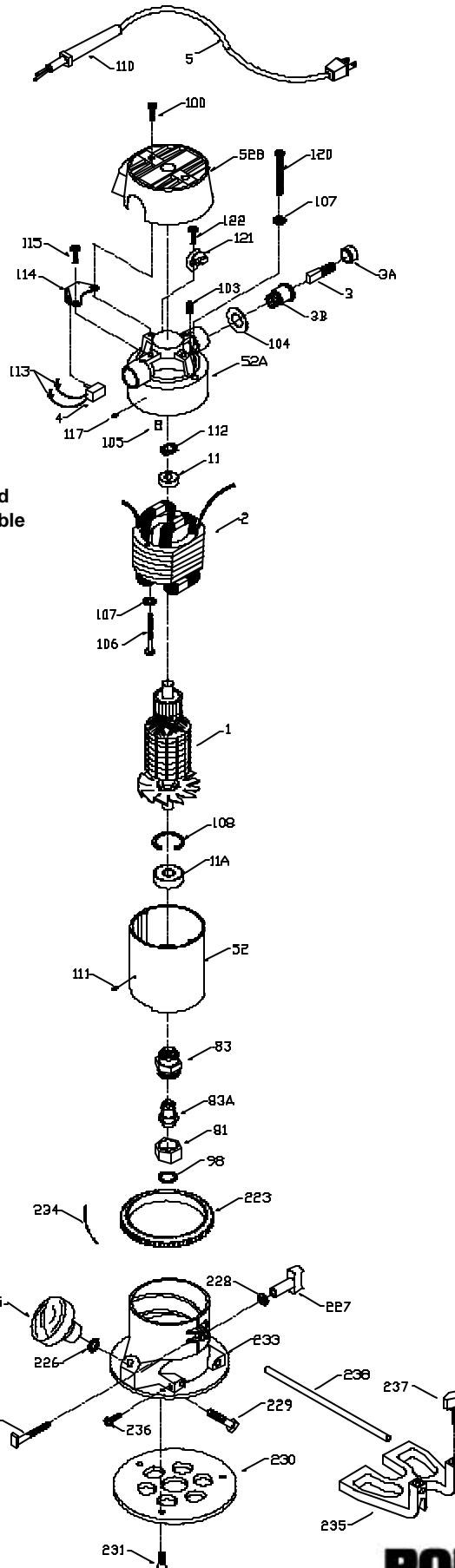

**WARNING:** Electrical repairs should only be attempted by trained repairmen. Contact the nearest Porter-Cable Service Center or other competent repair center.

# 6301

# 6302

# 6702

# 6902

# 513T6/T7

**NOTE:** 513T6 uses 6902 T5 Service Parts, except Ref. #52.  
513T7 uses 6902 T6 Service Parts, except Ref. #52.

Ref.	No.	Part No.	Description
1	n	694209	Armature, 6302 T2, T3, T4
		683459	Armature, 6302 T1
		683460	Armature, 6702
		699328**	Armature, 6902 T2, T3, T4, T5, T6
		682058	Armature, 6902 T1
2		874588	Armature, 220V
		694210	Field, 6302 T2, T3, T4
		683461	Field, 6302 T1
		683462	Field, 6702 - CF
		699326	Field, 6902 T2, T3, T4, T5, T6
3		682114	Field, 6902 T1
		874589	Field, 220V
3A		824216	Brush
3B		803483	Brush Cap
4		873497	Brush Holder
		842606	Switch
5		876320	Switch, 220V
		846674**	Cord, 6302 T4, 6902 T5, T6
		875697**	Cord, All 120V Except 6302 T4, 6902 T5
11		876314	Cord, Euro, 220V
		855284	Commutator Bearing
11A		878065	Fan Bearing, T2, T3, T4, T5, T6
		858525	Fan Bearing, T1
52	n	858457	Front Housing, Except 513
		873435	Front Housing, 513
		896687	Rear Housing Incl.: Ref. 103
		888727	Housing Cap
		875893	Collet Nut
		872793**	Chuck
		42999**	1/4" Collet Assy., Incl: Ref. 81, 98
		876669	1/4" Collet
		42975**	3/8" Collet Assy. (Optional), Incl.: Ref. 81, 98
		876670	3/8" Collet
98		42950**	1/2" Collet Assy., Incl.: Ref. 81, 98
		876671	1/2" Collet
		823030	Snap-Ring
100		878813	Motor Housing Cap Screw
103		803632	Set Screw 10-24 X 1/4" T6
		804360	Set Screw 8-32 X 3/16" T1, T2, T3, T4, T5
104		803496	Washer
105		842597	Bearing Plug
		881082	Screw, 6302 T2, T3, T4
		838310	Screw, 6302 T1
		838312	Screw, 6702 T1, 6902 T2, T3, T4, T5, T6
		863393	Screw, 6902 T1
107		802430	Washer, 6902 T1, 6302 T2, T3, T4
108		802426	Snap Ring
110		843464**	Strain Relief 6302 T4, 6902 T5, T6
111		800835	Guide Pin
112		842610	Load Spring, Early Units Only

Ref.	No.	Part No.	Description
113		682063	Connector
		842598	Switch Bracket, 120V
114		876396	Switch Bracket, 220V
		802764	Switch Bracket Screw
115		801374	Spec. Plate Screw, Early Units Only
117		838310	Front Housing Screw
120		874137**	Cord Clamp
121		848564	Clamp Screw
122		872998	Depth Adjusting Ring
223		800995	Knob, 2 1/4" Dia.
225		803674	Knob, 2 Dia.
226		801821	Lockwasher
227		874582	Clamp Wing Nut
228		823374	Clamp Washer
229		802306	Knob Screw
230		42186	Sub Base, Incl.: Ref. 231
231		688860	Screw, Sub Base With Countersunk Holes
232		874117	Screw, Sub Base With Counter-Bored Holes
		842580	Clamp Screw
233		875811	Base Housing, Incl.: Ref. 227, 228, & 232
234		886264	Base Housing, 90690 Commemorative
		800869	Depth Adjusting Ring Spring
235		42160	Edge Guide, Incls: Ref. 236, 237, 238
236		803160	Edge Guide Screw
237		882810**	Edge Guide Knob
238		824588	Edge Guide Rod, 10", Current
*		800876	Edge Guide Rod, 7", Early
*		803104	Field Lead
*		874299**	Armature Fan, 6302 T4, 6902 T5, T6 W/Plain Shaft
*		696328**	Armature Fan, T2 With 3/4" Bore, T3, 6902 T4, And (6302 T4, 6902 T5) With Knurled Shaft
*		694679	Armature Fan, T2, With 5/8" Bore
*		680913	Armature Fan, T1
*		849314	Terminal
*		695474	Cutter Shaft & Screw Assy.513
*		800198	Cutter Mounting Screw
ACCESSORIES: (Optional)			
*		43117	3/8" Pocket Cut Bit
*		26794	Carrying Case, Metal
*		44360	Carrying Case, Metal 693
*		888190	Carrying Case, Plastic 693PK
*		891589	Carrying Case, Plastic 9690
*		42596	Wrench, 1 1/8"
*		42914	Wrench, 1"
*			Not Shown
**			See Service Notes

6301

6302

6702

6902

513T6/T7

# SERVICE NOTES

## ARMATURES (T2, T3, T4)

6302: Type 2 armatures have steel fans. Type 3 armatures have plastic fans. Both (T2 and T3) are interchangeable. Only the T3 will be supplied for service.

6902: Type 2 armatures have steel fans. Type 3 armatures have plastic fans. Type 2, Type 3, and Type 4 armatures are interchangeable. . Only the T4 will be supplied for service.

## CHUCKS

Early chucks (694876) required a 1" wrench (42914). The current chuck (872793) requires a 1 1/8" wrench (42596). Only the current chuck (872793) will be supplied for service. When an early chuck (1") is replaced, a new wrench (42596, 1 1/8") will be required.

## CORD / STRAIN RELIEF / CORD CLAMP

Early models used cords with "molded-on" strain relievers. Current models use cords with a separate strain reliever. The separate strain reliever requires a new cord clamp (874137). The new cord clamp (874137) may be used with either style cord/reliever. The new cord clamp (874137), cord (846674), and strain reliever (843464) may be used as a set to service older units. This combination is recommended.

**DO NOT** install the new cord and strain reliever with the old style cord clamp (858588).

## ARMATURES FANS (6302 T4, 6902 T5)

Early 6302 T4 and 6902 T5 models used armature shafts with knurled fan mounting areas. Later units have ground fan mounting areas (no Knurl).

The replacement fan for knurled shafts is #696328.

The replacement fan for ground shafts (no knurl) is #874299.

## EDGE GUIDE KNOB

Early edge guides used thumbscrews. Later units use knobs. The knobs can be used on all versions. Only the knob will be supplied for service.

## WIRING DIAGRAMS

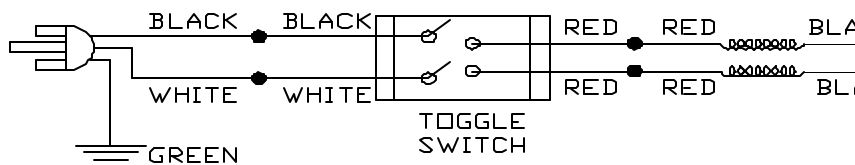

120V WIRING DIAGRAM

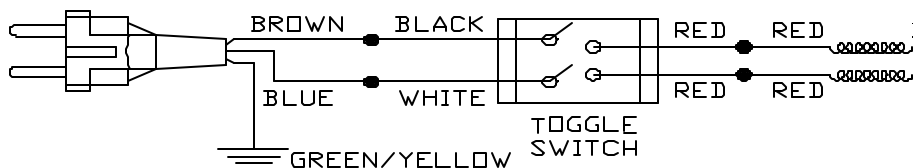

230V WIRING DIAGRAM