

PORTER-CABLE

ROUTER

WARNING: Electrical repairs should only be attempted by trained repairmen. Contact the nearest Porter-Cable Service Center or other competent repair center.

1001
1001H
1002
1002H

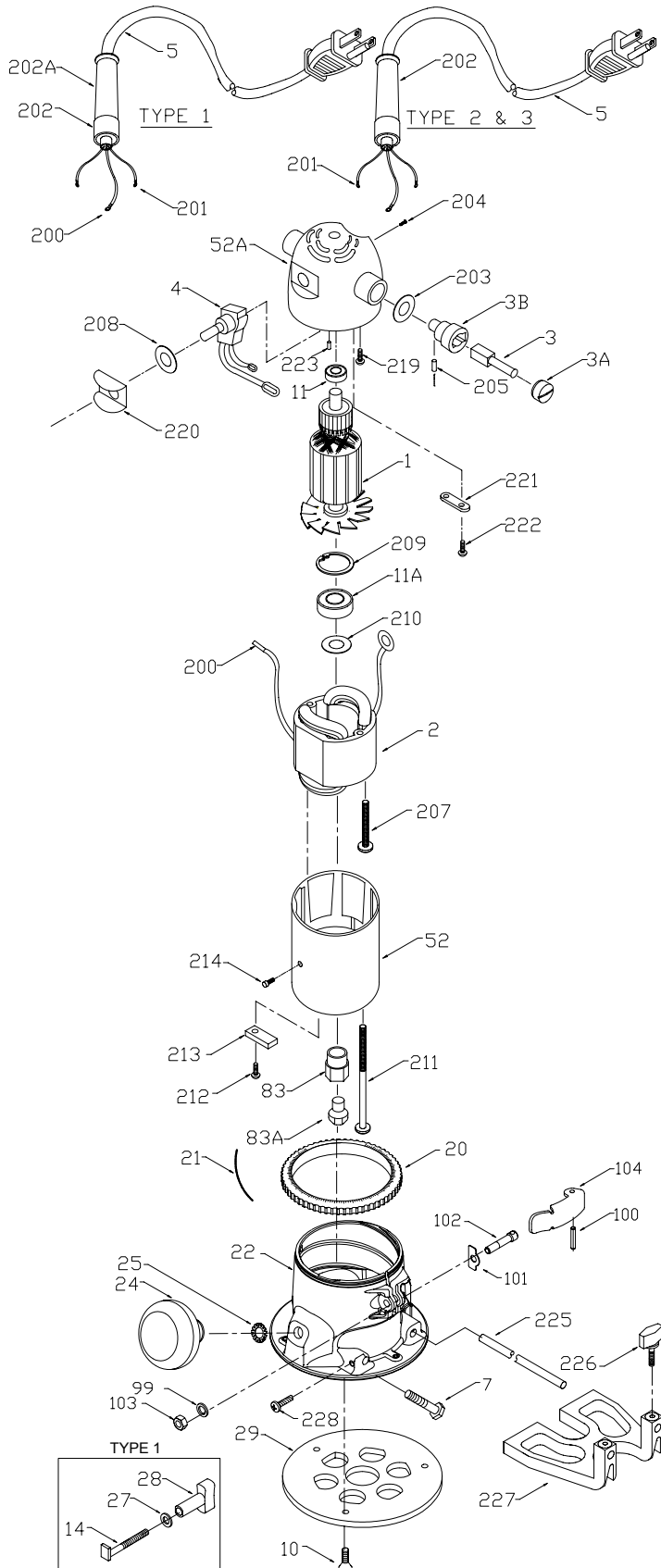

Ref. No.	Part No.	Description
1	680978 **	Armature
2	680963 **	Field
3	800838	Brush
3A	801538	Brush Cap
3B	800831 **	Brush Holder
4	842606 **	Switch
5	846674	Cord
7	802306	Knob Screw
10	688860	Screw (Sub-Base with Countersunk Holes)
	874117	Screw (Sub-Base with Counter-Bored Holes)
11	855216	Bearing, Comm End
11A	855203	Bearing, Fan End
14	842580	Clamp Screw, 1001 T1
20	872998	Depth Adjusting Ring
21	800869	Spring, (Retains Depth Adj. Ring)
22	875811	Base Housing, 1001T1, Incl.: Ref. 14, 27, & 28
	n 903010	Base Housing, 1001T2
	n 907398	Base Housing, 1001H
24	800995	Knob (2 1/4" Dia., Current)
	803674	Knob (2" Dia., Early)
25	801821	Lock Washer
27	823374	Clamp Washer, 1001 T1
28	874582	Clamp Knob, 1001 T1
29	42186	Sub-Base
52	800828	Lower Motor Housing, Incl.: Ref. 214
52A	695427**	Rear Motor Housing, 1002, T2, T3, Incl.: Ref. 223
	n 907399**	Rear Motor Housing, 1002H
83	800879	Chuck
83A	42154	Collet, 1/4" Capacity
99	n 802417	Lock Washer, 1001 T2 & 1001H
100	n 903118	Pin, 1001 T2 & 1001H
101	n 903119	Wear Plate, 1001 T2 & 1001H
102	n 903120	Shaft, 1001 T2 & 1001H
103	n 847267	Hex Lock Nut, 1001 T2 & 1001H
104	n 903114	Buckle, 1001 T2 & 1001H
200	802303	Terminal
201	849314	Ground Wire Terminal
202	810716	Strain Reliever, T2, T3
	802202	Bushing, T1 Only
202A	872766	Spring, T1 Only
203	802223	Brush Holder Washer
204	801896	Spec. Plate Screw, (Early)
205	802388	Brush Holder Screw
207	857566 **	Field Screw
208	695419	Spacer
209	802302	Retaining Ring
210	800865	Dust Shield, Fan End
211	876110	Screw
212	884892	Clip Screw, (Early)
213	800856	Clip (CF) (Early)
214	800835	Pin
219	852310	Ground Screw (Current, #6-32)
	844107	Ground Screw (Early, #8-32)
220	800859	Switch Guard
221	861434	Cord Clamp, T2, T3
222	n 882187	Screw, T2, T3
223	842597	Rubber Plug (Late T3)
*	803105	Brush Holder Lead
*	42157	Wrench, Chuck & Collet
*	874568 **	Armature Fan (Plastic Fan for Shaft without Knurl)
*	696528 **	Armature Fan (Plastic Fan for Shaft with Knurl)
*	857763 **	Armature Fan (Centrifugal), (CF)
ACCESSORIES: (Optional)		
225	824588	10" Guide Rod (Current)
	800876	7" Guide Rod, (Early)
226	882810	Thumb Screw
227	42160	Edge Guide Assy., Incl.: Ref. 225, 226, 228
228	803160	Screw
*	Not Shown	
**	See Service Notes	

1001

1001H

1002

1002H

SERVICE NOTES

REAR MOTOR HOUSING T1 - REF. 52A

The T1 motor housing # 800861 is no longer available. When replacing this housing it is necessary to use the T2 & 3 housing # 695427, # 810716 strain relief, # 861434 cord clamp, and 2 # 844009 cord clamp screws.

MOTOR (AIR FLOW)

Early models utilized a centrifugal fan and baffle to cool the motor. Repairs involving currently produced armatures incorporating an axial fan will require removal of baffle and related parts.

To convert to axial fan, remove baffle #800813 and insulating baffle #800844

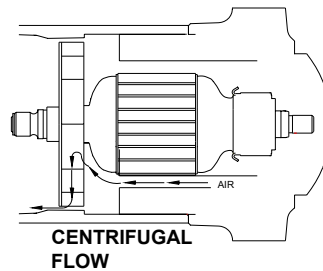
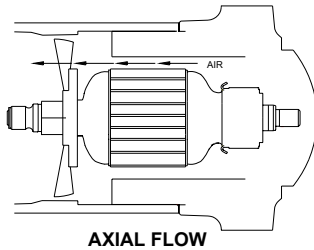

ELECTRICAL INTERCHANGEABILITY

Early models incorporated motors wound in reverse pattern. Mixing patterns between armatures and fields generates commutator sparking and reverse rotation. Motor replacement should be made in sets of matching armature and field.

ARMATURES/FANS

Current armatures use a plastic, axial flow fan. Previous armatures used a steel, axial flow fan. These two types of armatures are interchangeable.

When replacing a fan only: use the same type replacement fan (steel or plastic) as the original fan.

MOTOR

CAUTION: Always check rotation after any motor repair but never check rotation with cutter in place.

FIELD SCREWS

To prevent screws from loosening, it is recommended that Loctite be applied to both field screws.

FIELD

Currently produced units will incorporate a two lead field and a single pole switch as opposed to early four lead field and double pole switch. Any combination of 2 or 4 lead and single or double pole switch may be used by following the wiring diagrams below.

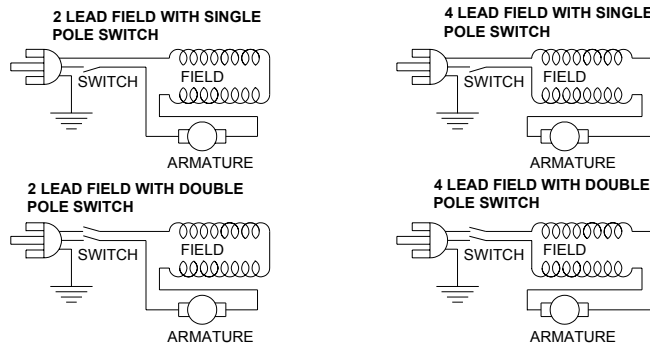

BRUSH HOLDER

Some units were manufactured with washer #845787 assembled behind brush holder #800831 to prevent excessive heating.