



SERVICE PARTS LIST

BUL. 54-32-1002

7" POLISHER

REVISED BUL 6100-3 DATE Feb. '68

MODEL NO. P-175

Starting Serial No. 100-2100

WIRING INSTR.

Both Model and Serial No. must be furnished to obtain correct parts.

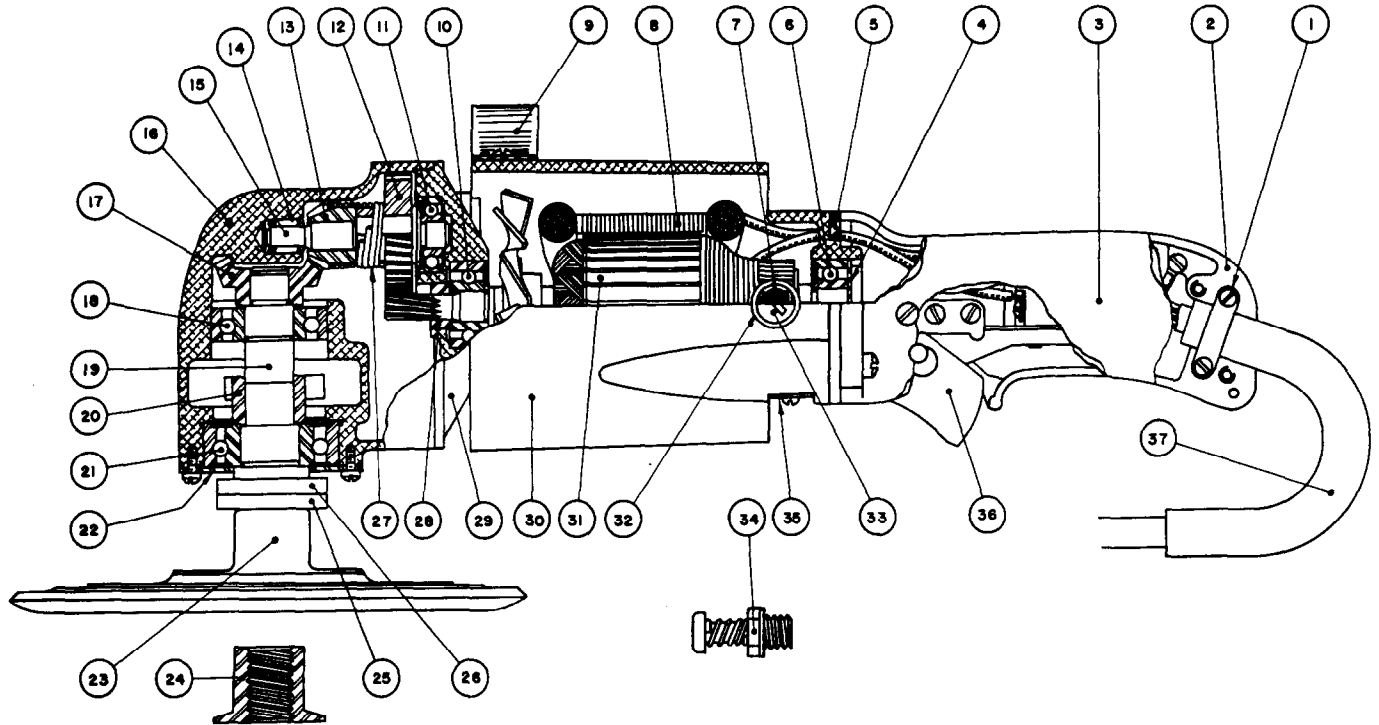

ILLUSTRATED PARTS

FIG.	PART NO.	NAME OF PART	FIG.	PART NO.	NAME OF PART
1	7UPV1-5	Cord Clamp Strap	19	75P-8	Spindle
2	7UPV1-1	Handle (Switch Mounting Side)	20	3UP8-8	Spindle Locking Cog
3	7UPV1-2	Handle (Switch Cover Side)	21	WC87504	Spindle Ball Bearing (lower)
4	6UPV1-9	Body End Play Disc	22	3UP8-3	Ball Bearing Retaining Washer
5	6UPV1-3	Handle Insulator	23	75P-180	Rubber Backing Pad
6	WC8009	Armature Ball Bearing (Comm. End)	24	75P16-2	Disc Nut (5/8-11 Thread)
7	38M-370	Carbon Brush Assemblies (per set) ..	25	3UP8-2A	Hub Rubber Washer
8	38M-700	Field Assembly	26	3UP8-1A	Hub Steel Washer
9	75P1-1A	Tool Rest	27	75P13-2	Drive Spring
10	WC8500	Armature Ball Bearing (Pinion End) ..	28	75P6-9	Grease Slinger
11	N.D.7039	Intermediate Shaft Ball Bearing	29	75P-2	Diaphragm
12	75P-14	Intermediate Gear	★30	75P-1B	Motor Housing
13	75P13-1	Pinion Gear (Sold only with 75P-11/ as a set) per set	★31	75P-600	Armature Assembly
14	B-47	Intr. Shaft Needle Bearing	★32	75P-320	Brush Holder Assemblies (per set 2)
15	75P-13	Intermediate Shaft	★33	75P-40	Brush Retaining Cap (2)
16	75P-3	Gear Case	34	3UP-900	Spindle Lock Assembly
17	75P-11	Bevel Gear (see item 13)	35	75P1-2	Commutator Cover Plate
18	N.D.3203	Spindle Ball Bearing (upper)	36	8909K200	Switch Assembly
			37	88D-28	Cord Protector Tube

MISCELLANEOUS PARTS NOT SHOWN

SIZE OR PART NO.	DESCRIPTION OF PART	SIZE OR PART NO.	DESCRIPTION OF PART
P-175	Name Plate	#8-32x5/16" Bind. Hd.	Switch Mounting Screws (2)
#16	Cord (3-wire) per foot	#6-32x1/4" (Brass)	Rd. Hd. Ground Wire Screw (1) ..
75P-41	Wooden Side Handle Assembly ...	#8-32x1" Oval Hd.	Handle Cover Screw (1)
3P-1	Attachment Plug (1)	#8-32x7/16" Fil. Hd.	Cord Clamp Strap Screws (2)
#10-24x1/2" Fil. Hd.	Sem. Tool Rest Screw (2)	#8-32x2-1/8" Fil. Hd.	Field Screws (2)
#12-24x3/4" Fil. Hd.	Switch Handle Screws (4)	#6-32x1/4" Rd. Hd.	Commutator Cover Screws (2) ...
#10-24x3/4" Fil. Hd.	Gear Case Screws (4)	#6-32x5/16" Fil. Hd.	Ball Brg. Retaining Washer Scs(6)
#8-32x7/8" Oval Hd.	Handle Cover Screws (2)	#4-36x3/16" Rd. Hd.	Name Plate Screws (2)
1/4-20x3/8" Unbrako	Knurled Point Socket Hd., Hd'less Brush Holder Set Scs.(2)	3PA-1	Attachment Plug Adaptor